

NOTES:
 HOUSING: HIGH TEMPERATURE HOUSING UL94V-0
 WITHSTANDS IR AND VPR SOLDERING METHODS.
 CONTACTS: PHOSPHOR BRONZE.
 PLATING: GOLD PLATED.
 ELECTRICAL CHARACTERISTICS:
 CURRENT RATING:0.3 AMP.
 INSULATOR RESISTANCE:1000MΩ MIN. AT DC 250V.
 CONTACT RESISTANCE: 90MΩ MAX. AT DC 100MA.
 OPERATING TEMPERATURE:-55°C ~+85°C .

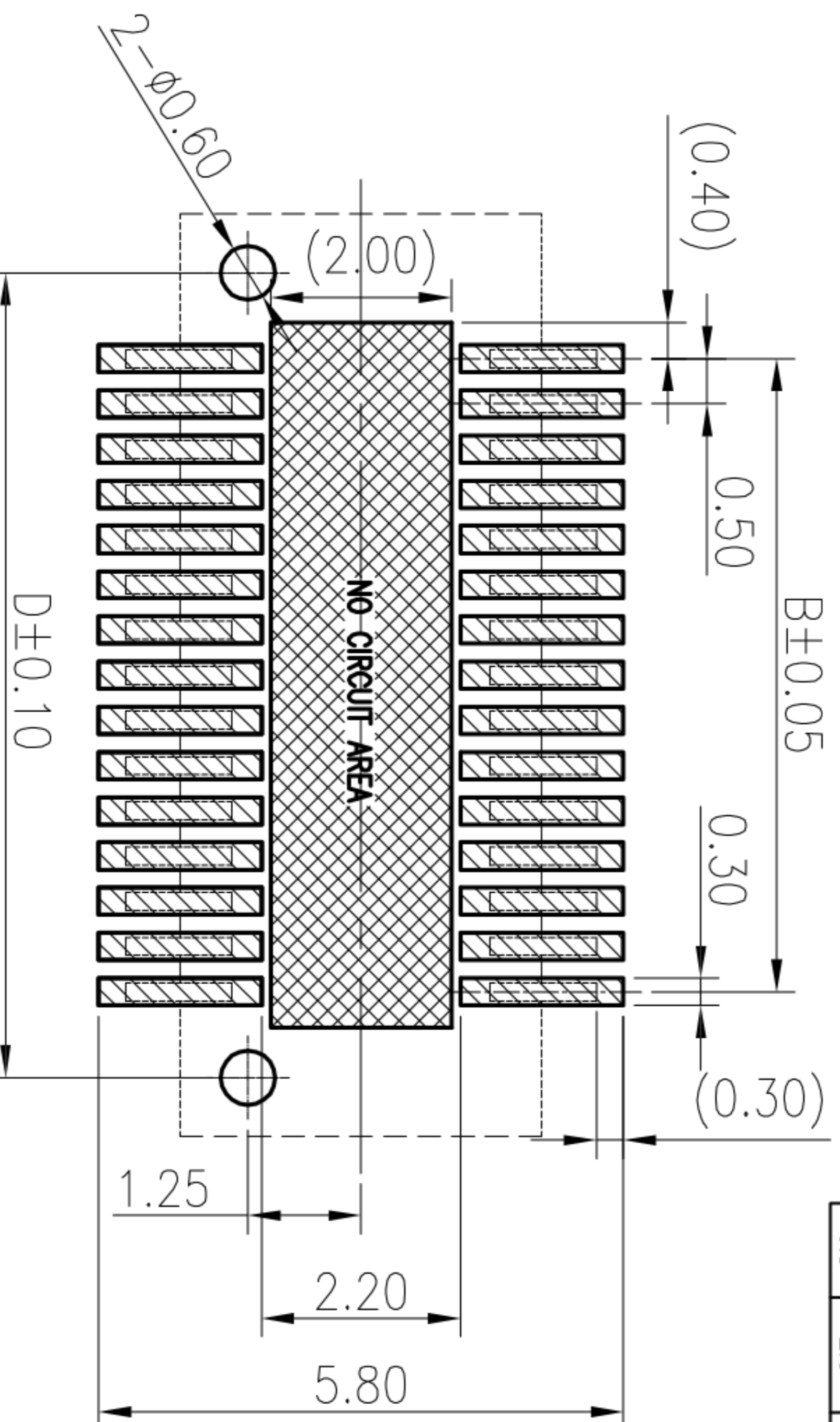
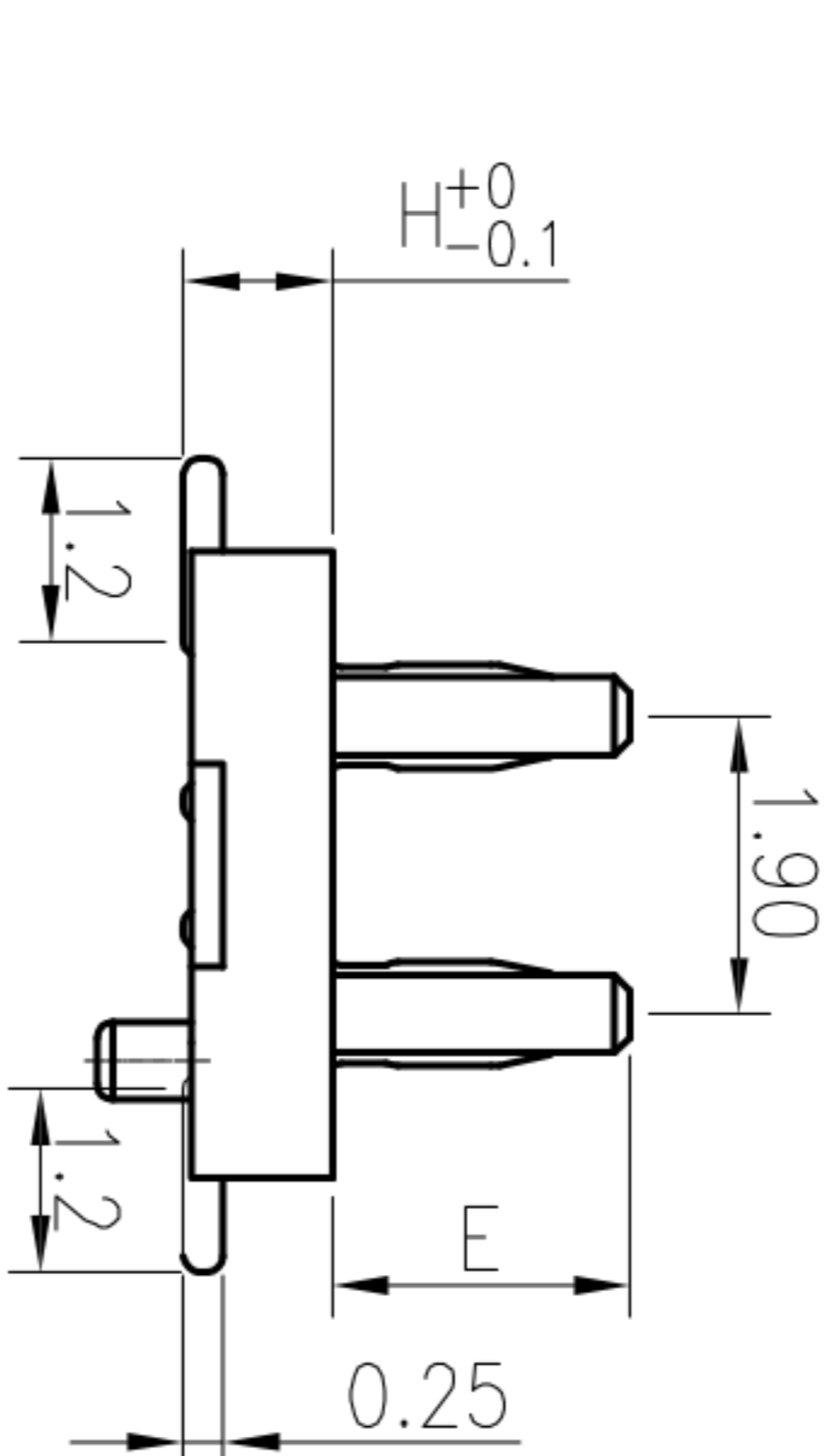
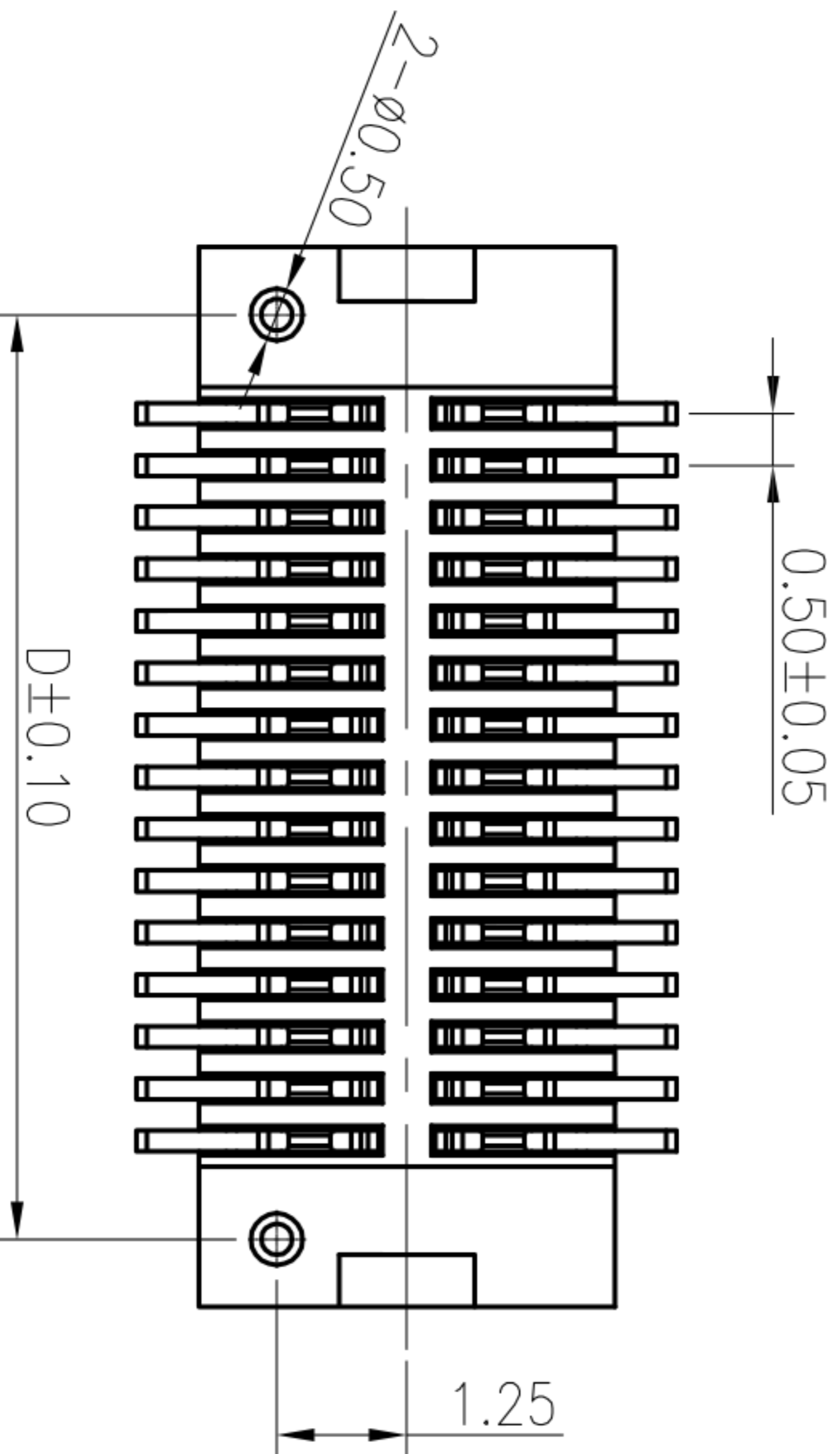
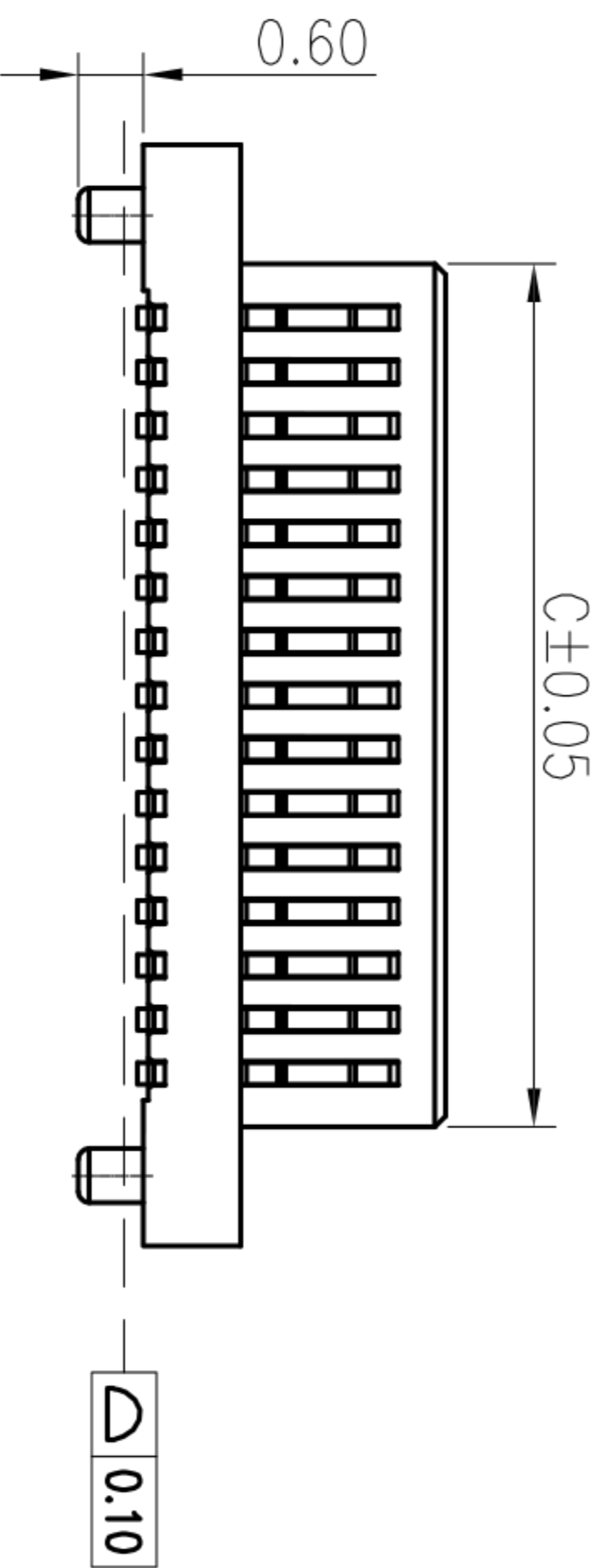

RECOMMENDED PCB PATTERN DIM.
 TOLERANCE : ±0.05

MATING HEIGHT	PLUG (H)	SOCKET (H)	E	Dimensions				Dimensions				
				A	B	C	D	A	B	C	D	
3.0	0.8	2.2	1.6	3.70	0.50	1.50	2.40	54	16.20	13.00	14.00	14.90
3.5	1.3	2.2	1.6	4.20	1.00	2.00	2.90	56	16.70	13.50	14.50	15.40
4.0	1.0	3.0	1.9	4.70	1.50	2.50	3.40	58	17.20	14.00	15.00	15.90
4.5	1.0	3.5	1.9	5.20	2.00	3.00	3.90	60	17.70	14.50	15.50	16.40
5.0	1.0	4.0	1.9	5.70	2.50	3.50	4.40	62	18.20	15.00	16.00	16.90
5.5	2.0	4.5	1.9	6.20	3.00	4.00	4.90	64	18.70	15.50	16.50	17.40
6.0	2.0	4.0	1.9	6.70	3.50	4.50	5.40	66	19.20	16.00	17.00	17.90
6.5	2.0	4.5	1.9	7.20	4.00	5.00	5.90	68	19.70	16.50	17.50	18.40
				7.70	4.50	5.50	6.40	70	20.20	17.00	18.00	18.90
				8.20	5.00	6.00	6.90	72	20.70	17.50	18.50	19.40
				8.70	5.50	6.50	7.40	74	21.20	18.00	19.00	19.90
				9.20	6.00	7.00	7.90	76	21.70	18.50	19.50	20.40
				9.70	6.50	7.50	8.40	78	22.20	19.00	20.00	20.90
				10.20	7.00	8.00	8.90	80	22.70	19.50	20.50	21.40
				10.70	7.50	8.50	9.40	82	23.20	20.00	21.00	21.90
				11.20	8.00	9.00	9.90	84	23.70	20.50	21.50	22.40
				11.70	8.50	9.50	10.40	86	24.20	21.00	22.00	22.90
				12.20	9.00	10.00	10.90	88	24.70	21.50	22.50	23.40
				12.70	9.50	10.50	11.40	90	25.20	22.00	23.00	23.90
				13.20	10.00	11.00	11.90	92	25.70	22.50	23.50	24.40
				13.70	10.50	11.50	12.40	94	26.20	23.00	24.00	24.90
				14.20	11.00	12.00	12.90	96	26.70	23.50	24.50	25.40
				14.70	11.50	12.50	13.40	98	27.20	24.00	25.00	25.90
				15.20	12.00	13.00	13.90	100	27.70	24.50	25.50	26.40

APPROVALS		DATE	深圳市联丰电子有限公司 SHENZHEN LIANFENG ELECTRONIC CO.,LTD					
DRAWN	ZHIWEI.CHEN	2015.07.07	TITLE:	0.5MM BTB 双槽立式公座h3.0~6.5	PART NO.	GP02-4XX-GXXP-B0R		
CHECKED			ANGLE	±2°	UNIT: mm	SCALE: 1:1		
APPROVALS			TOLERANCES ARE	30~以上 ±0.30 10~30 ±0.20 5~10 ±0.15 ~5 ±0.10	DRAWING NO.	PROJ:		
ECN NO.	REV.	DATE.	DESCRIPTION.	NEW	CHANGE.	CHECK.	APPRO.	SHEET 1 OF 1